

WHITEWATER

LA GRANGE

ROAD CLOSED
3/4 MILES AHEAD
LOCAL TRAFFIC ONLY

ROAD CLOSED
TO
THRU TRAFFIC

ROAD CLOSED
6 1/2 MILES AHEAD
AT HWY H / USH 12

DETOUR ROUTE
CONSTRUCTION ZONE

CONSTRUCTION STAGE I 2009
JULY 5th TO SEPTEMBER 15th

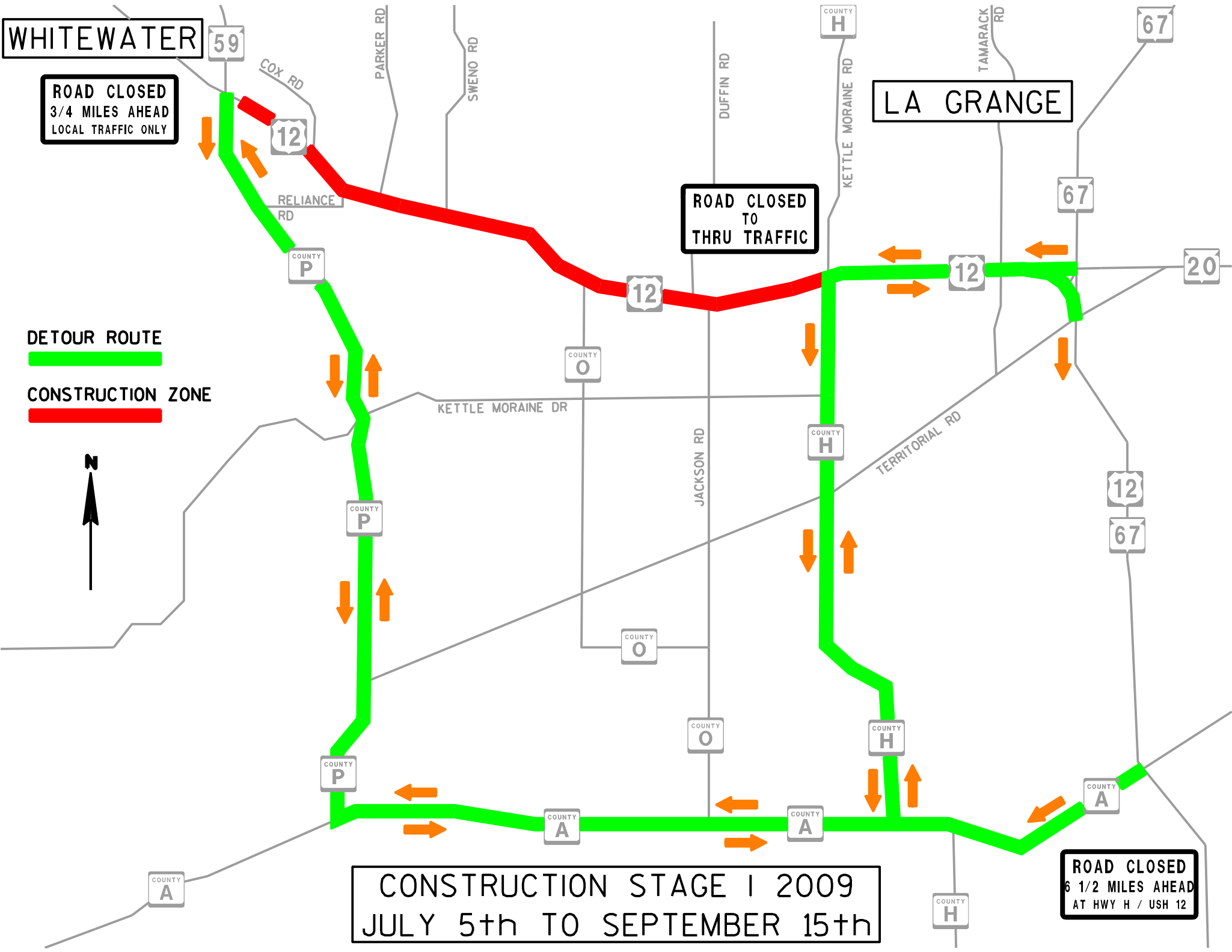

WHITEWATER

LA GRANGE

CONSTRUCTION STAGE II 2009
SEPTEMBER 15th THRU NOVEMBER 31st

DETOUR ROUTE
CONSTRUCTION ZONE

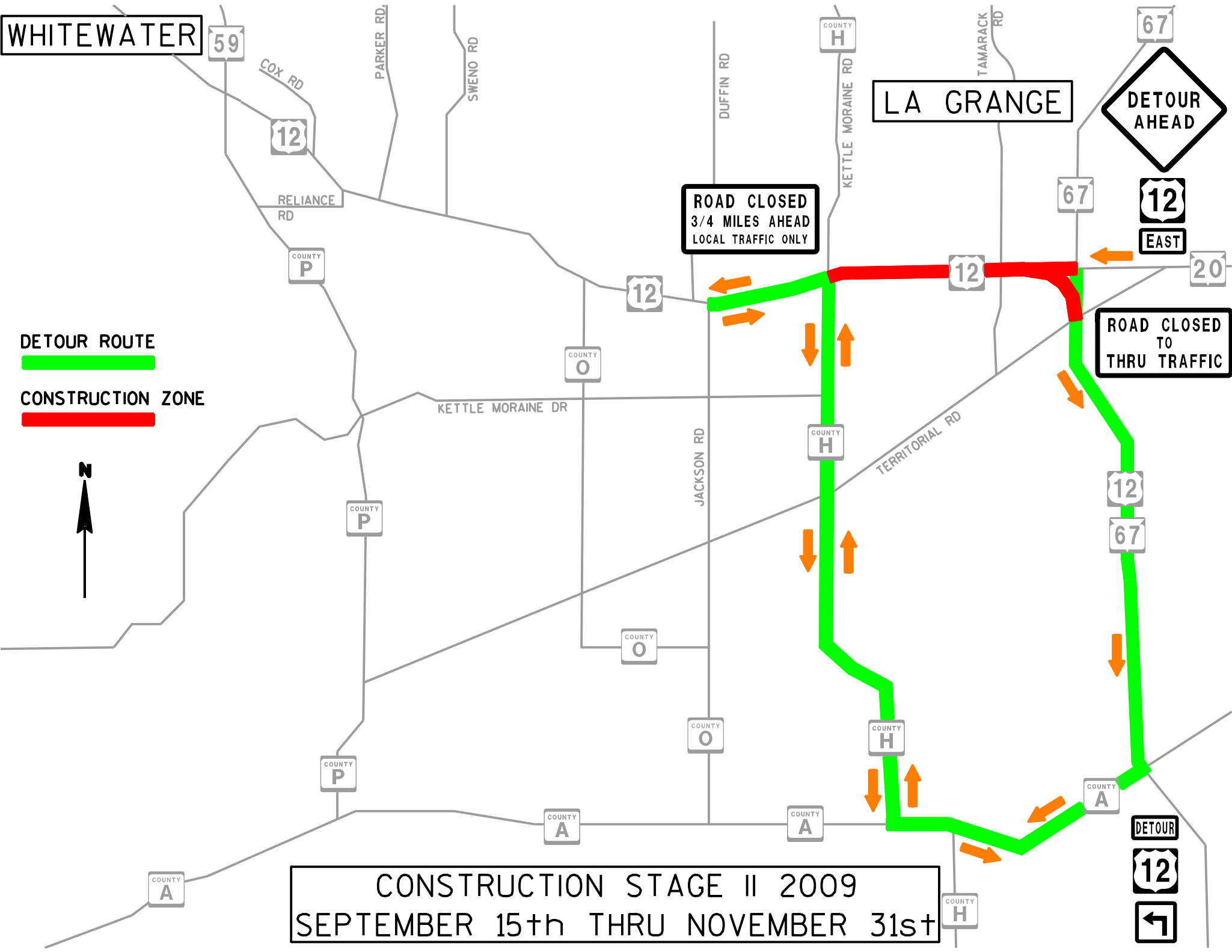

ROAD CLOSED
3/4 MILES AHEAD
LOCAL TRAFFIC ONLY

ROAD CLOSED
TO
THRU TRAFFIC



ROAD CLOSED
TO
THRU TRAFFIC

DETOUR



DETOUR



DETOUR



DETOUR



DETOUR



DETOUR



DETOUR



DETOUR



DETOUR



DETOUR



DETOUR



DETOUR



DETOUR



DETOUR



DETOUR



DETOUR



DETOUR



DETOUR



DETOUR



DETOUR



DETOUR



DETOUR



DETOUR



DETOUR



DETOUR

