



University of Wisconsin
Whitewater

Facilities Planning
and Management



Campus Address Re-Alignment Project

August 2019

CAMPUS ADDRESS RE-ALIGNMENT PROJECT

This project has been completed to improve emergency response, wayfinding and alignment with the City of Whitewater addressing grid. The address grid is maintained in an information technology platform for 911. Changes put in place ensure data in system is optimal for emergency response. This has been a joint effort between the City of Whitewater's Planning Office and Emergency Response and Dispatch Office and UW-Whitewater's Police Department, Parking Services, ICIT and Campus Facilities Planning Team.

In the days of online wayfinding and digital and mobile devices, this project will help ensure that local and county emergency response teams can quickly and effectively get to the needed destination. It should also help reduce and eliminate the number of non-authorized vehicles from driving onto pedestrian malls. It will also make wayfinding for our new students and visitors to campus much easier as they utilize their mobile devices for wayfinding.

PROCESS:

As we began working through gathering all available address data on campus facilities, it became clear that some buildings had multiple addresses without clear documentation on origination, and many of them did not align with the City of Whitewater's addressing grid, thus making location of the facility much more difficult. Addresses on pedestrian malls or non-existent streets (ie Graham Avenue and Case Street) that still showed up in online mapping programs, encouraged people to drive onto Wyman or Carter Mall, searching for addresses, thus endangering pedestrians. The primary goal of this project was to eliminate all addresses that were on a pedestrian mall, a vacated ROW (non-existent street) or addresses with a letter suffix. Additional goals were to: eliminate multiple addresses for each facility; align with addressing grid; and determine the best and most logical way emergency response would arrive at a facility if called. Included in address assessment and assignment are campus parking lots, outdoor areas where groups gather, emergency response phones (blue light phones) and future facilities. The result is that several buildings have a new address. These results have been vetted through the City of Whitewater and key campus groups related to emergency response and other life safety matters. The City will notify Jefferson and Walworth Counties to update this information within their databases. The University will follow-up with UW System and Department of Administration to complete these changes in any relative databases, including WisBuild, DOA's official facility database. UW-Whitewater ICIT department will work to update online mapping programs with this information.

IMPLEMENTATION:

These changes have already had a soft rollout for implementation, especially with new facilities such as the new residence hall at 451 Warhawk Drive. Other significant changes include:

- Hyer Hall is now 800 West Main Street and is **still** the official address for UW-Whitewater.
- The drive from Prairie Street to the entrance to the University Center loading dock area has been designated as a new university street name Hamilton Green Way. Several facilities have addresses on this new street. A diagram can be found on page 4 in this document.
- The Andersen Library building will now be referred to as Andersen Hall with a two letter designation of AN. The library itself will remain as Harold Andersen Library located within Andersen Hall.

Additional physical signage will be developed as needed and installed throughout campus to communicate this information.

Campus administration strongly encourages everyone to utilize the main campus address of 800 West Main Street on all communications. Efforts should be made by departments and divisions to make the needed changes to their websites, social media accounts, directories and any other materials where building addresses are used. Target is to be fully updated by the end of the calendar year (Dec 31, 2019). We recommend that a copy of the address crosswalk table be kept handy for the duration of the transition. A simplified version of this table can be found at <http://www.uww.edu/adminaffairs/fpm/campus-planning/current-projects>.

RESULTS:

The results of this project can be found on the following pages in both graphic and table format. Addresses with a change are shown in **bold red font** on the diagrams. Brown buildings on the following diagrams indicate proposed future facilities per the 2014 Comprehensive Master Plan, which can be found at <http://www.uww.edu/masterplan>. Questions can be directed to campusplan@uww.edu. Please use Address Re-alignment in the subject line.



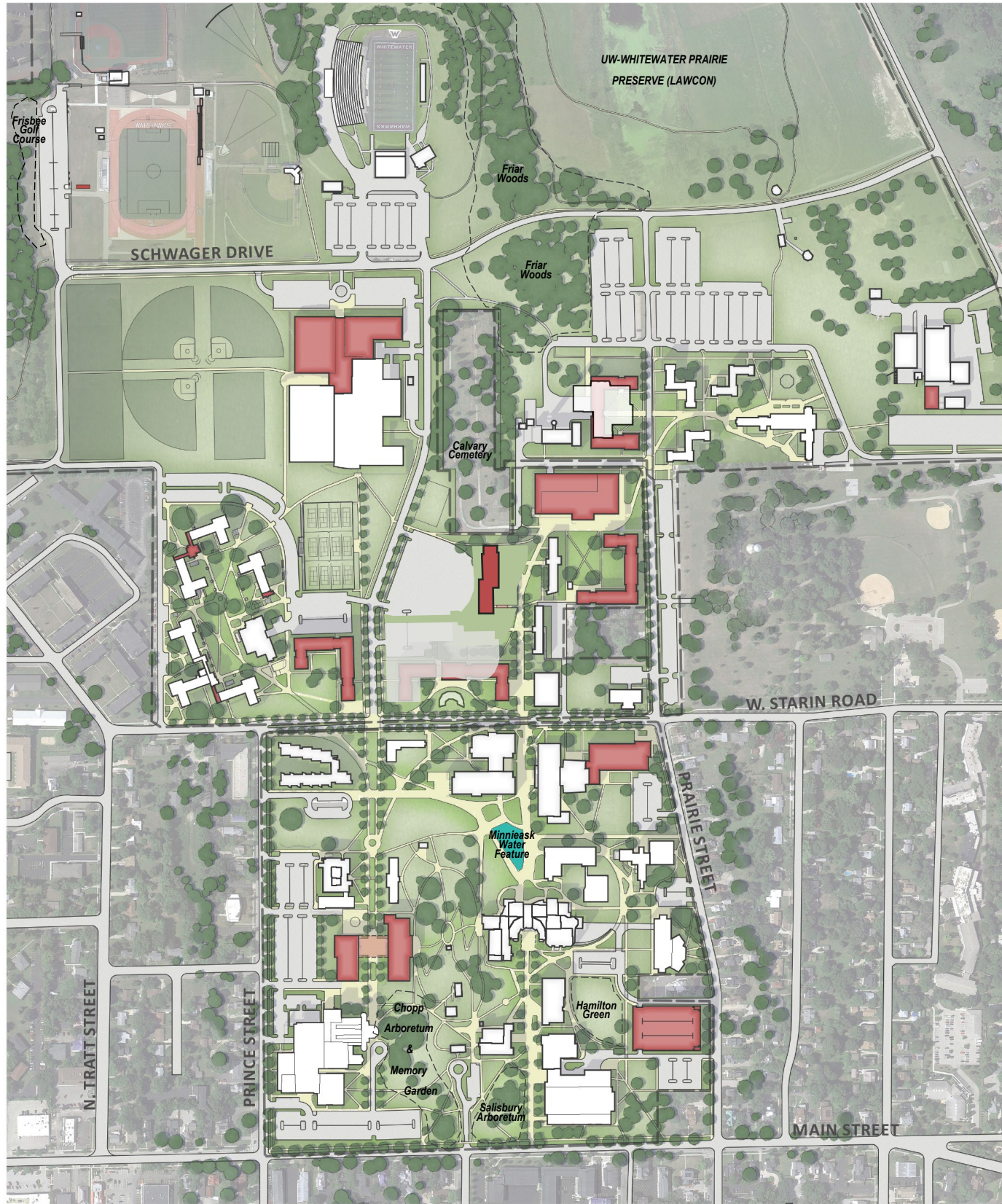

FIGURE 37: COMPREHENSIVE CAMPUS MASTER PLAN DETAIL



CONTENTS:

Cover

Project Background i

Campus Map and Table of Contents ii

North Prince Street and West Main Street Addresses 1

North Prince Street and West Starin Road Addresses 2

West Starin Road Addresses 3

Hamilton Green Way and North Prairie Street Addresses 4

North Prairie Street Addresses 5

West Lauderdale Drive and North Prairie Street Addresses 6

Lauderdale Drive, West Schwager Drive and Fremont Street Addresses 7

West Schwager Drive Addresses 8

West Schwager Drive Addresses 9

West Schwager, Warhawk and Koshkonong Drive Addresses 10

Koshkonong and Warhawk Drive Addresses 11

Address Crosswalk Table - Buildings..... 12

Address Crosswalk Table - Buildings continued..... 13

Address Crosswalk Table - Future Buildings..... 14

Address Crosswalk Table - Parking Lots 15

Address Crosswalk Table - Outdoor Areas and Athletic Fields 16

Address Crosswalk Table - Emergency Phones 17



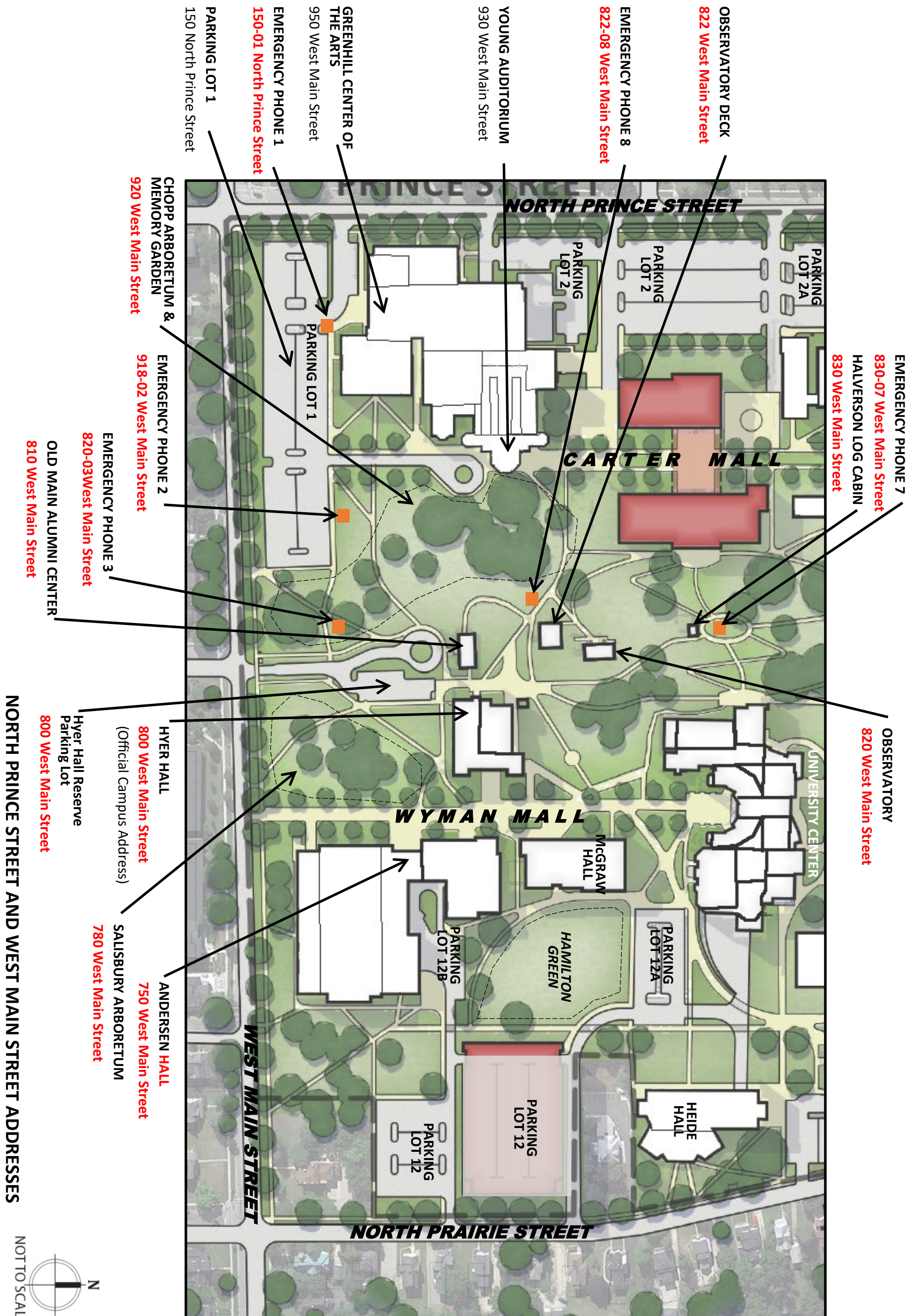

Revisions are shown in **BOLD RED** Brown buildings are proposed future buildings per Campus Master Plan



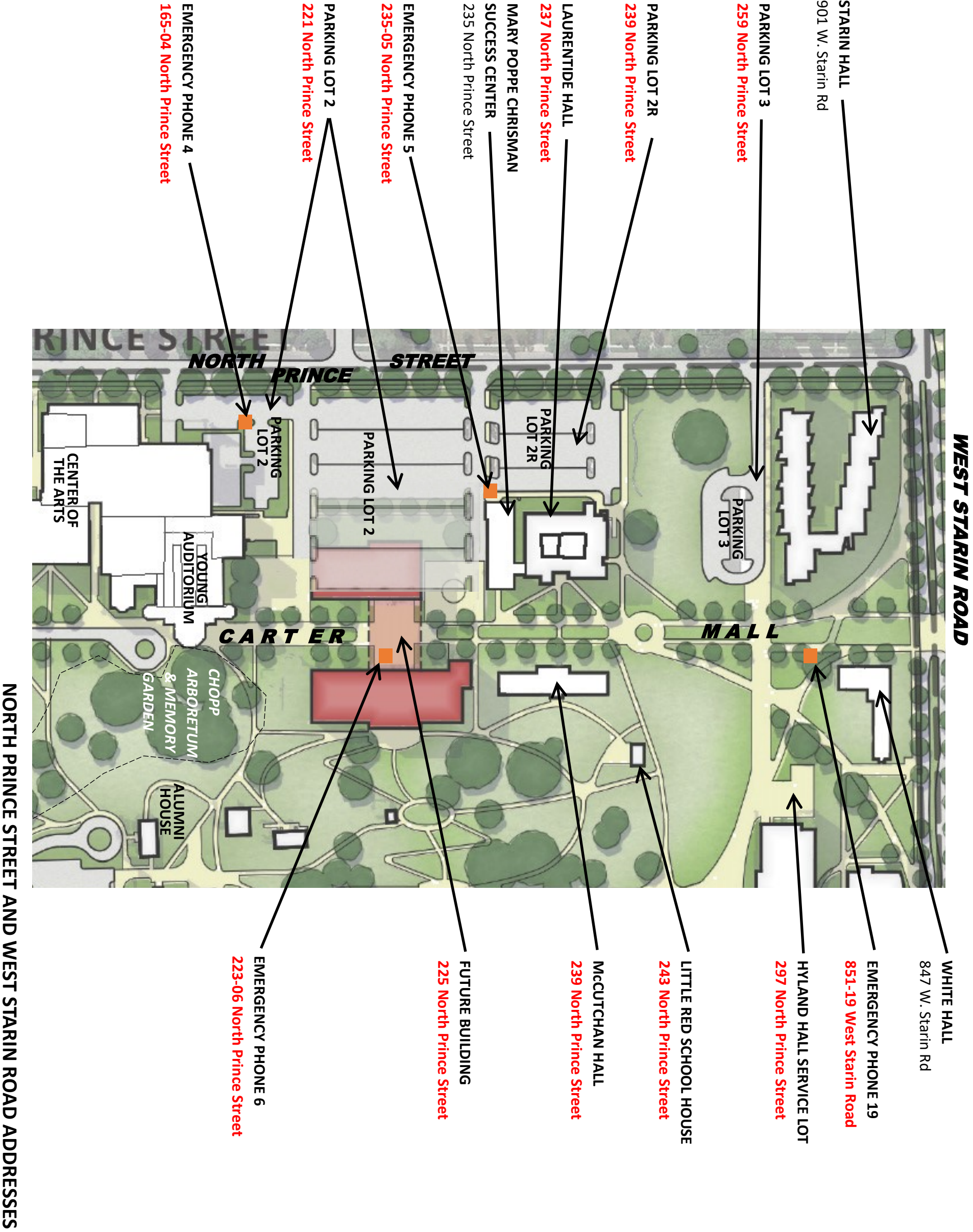

Revisions are shown in **BOLD RED**

Brown buildings are proposed future buildings per Campus Master Plan



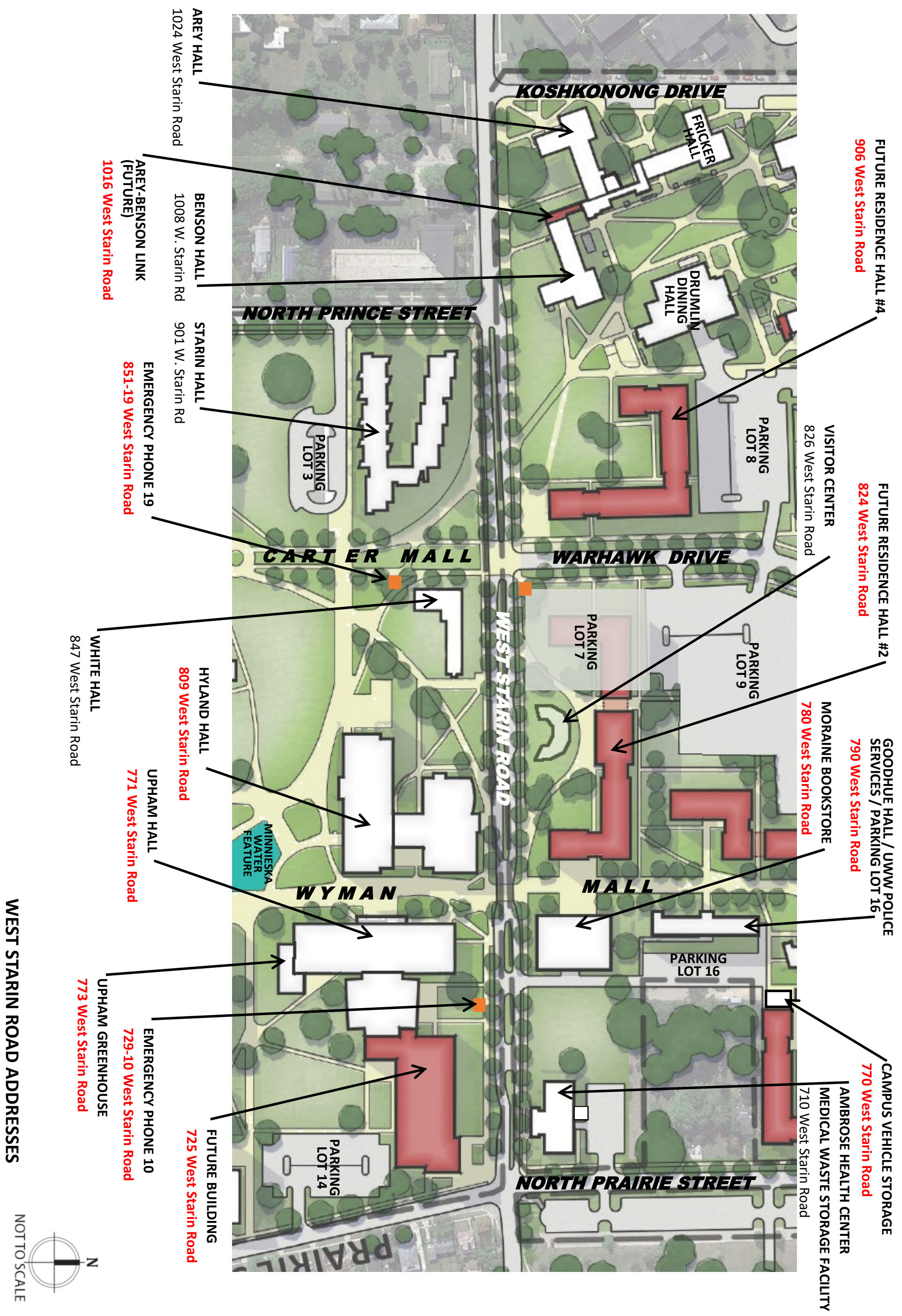

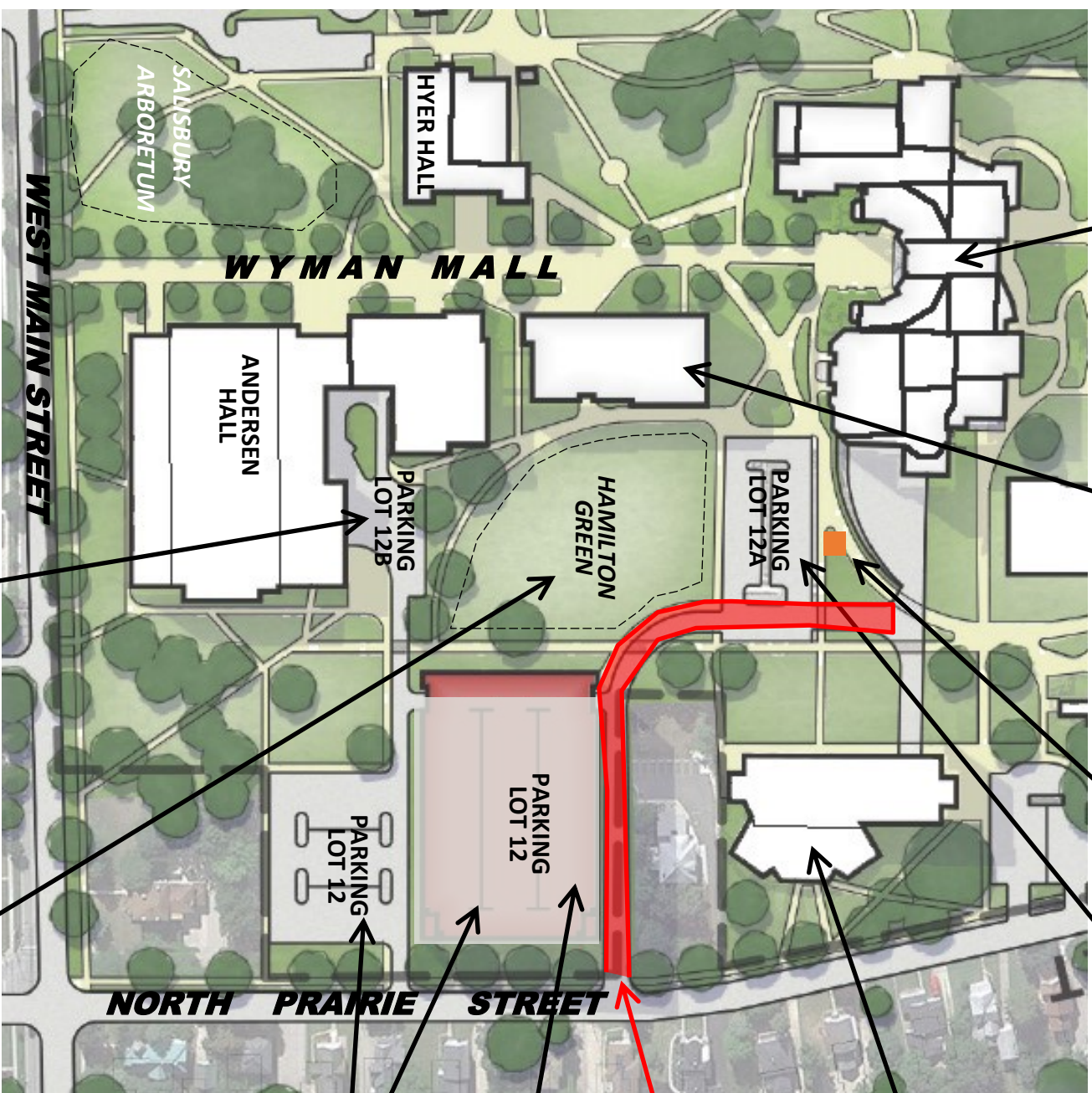

HAMILTON GREEN WAY (NEW UNIVERSITY ROAD) AND NORTH PRAIRIE STREET ADDRESSES

Revisions are shown in **BOLD RED**

Brown buildings are proposed future buildings per Campus Master Plan



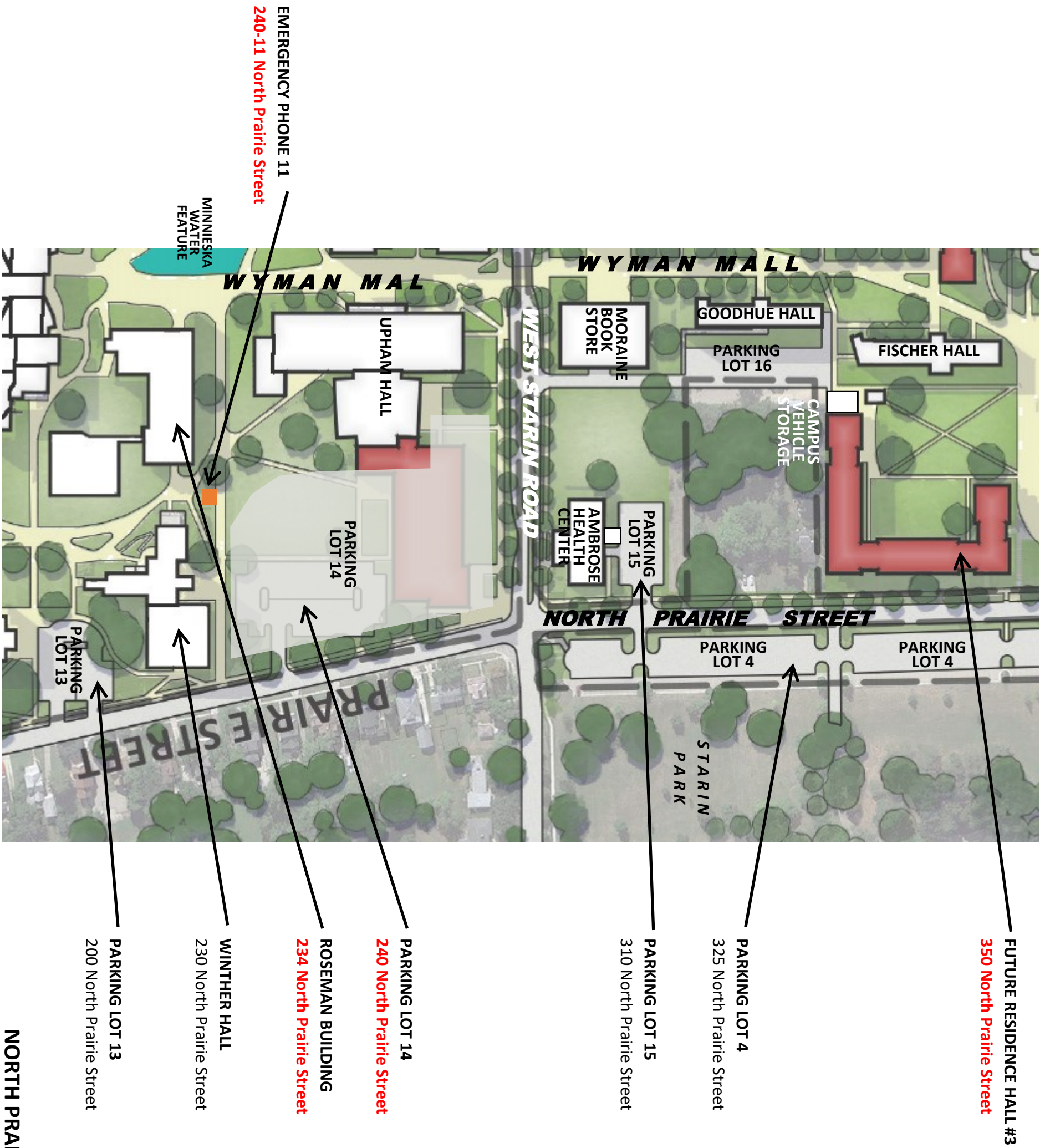

Revisions are shown in **BOLD RED**

Brown buildings are proposed future buildings per Campus Master Plan

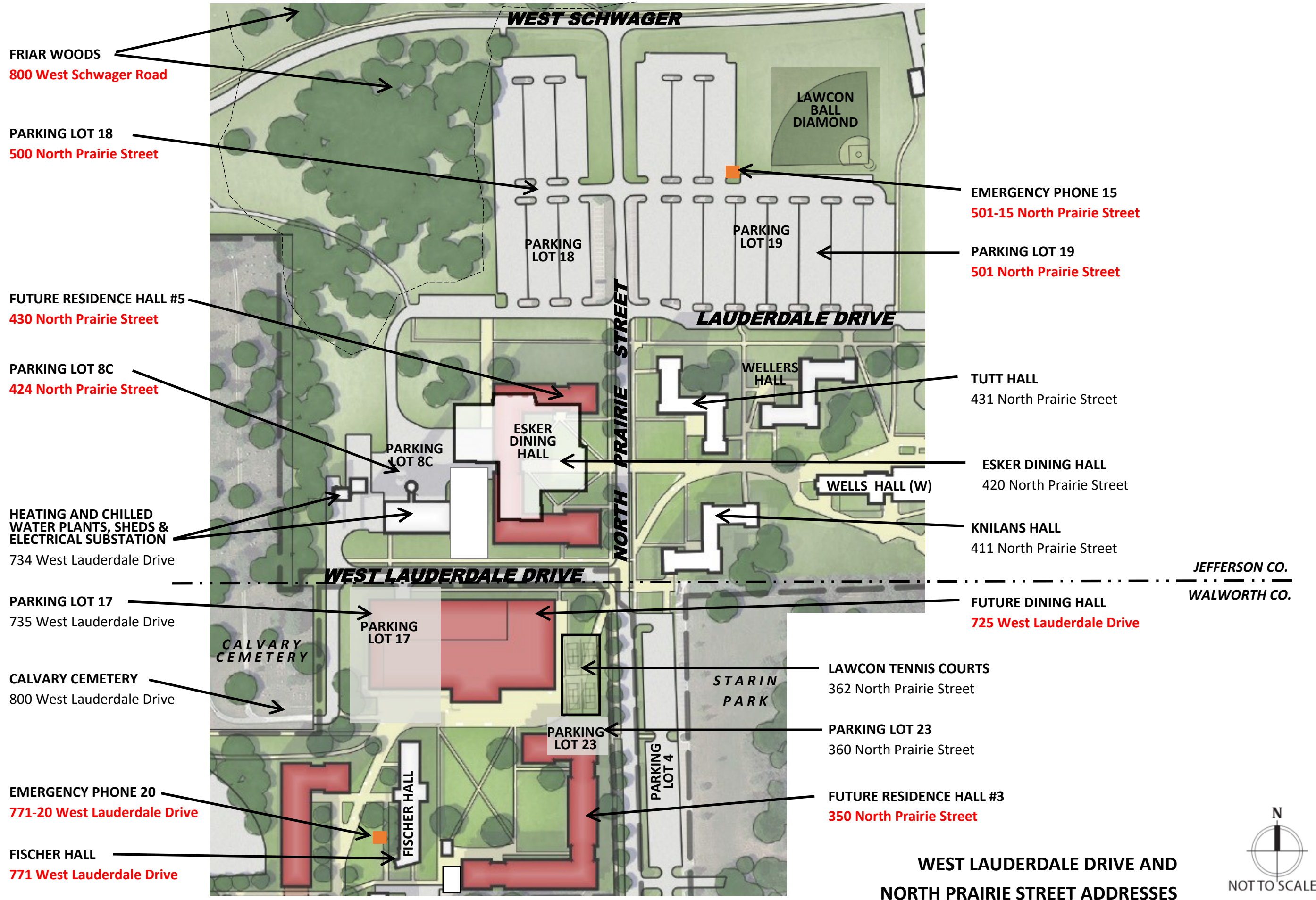

WEST LAUDERDALE DRIVE AND NORTH PRAIRIE STREET ADDRESSES



Revisions are shown in **BOLD RED** Brown buildings are proposed future buildings per Campus Master Plan



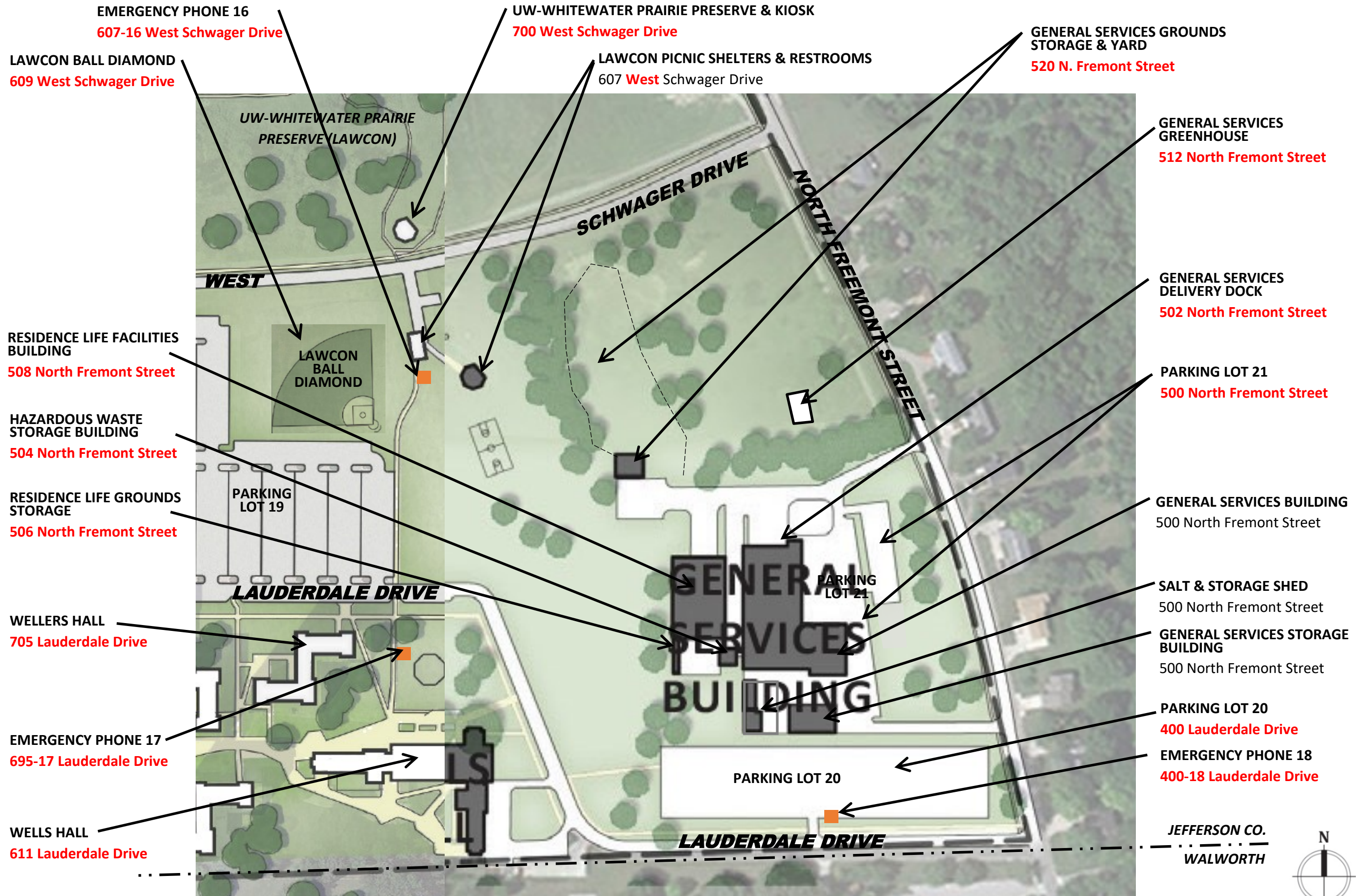

EMERGENCY PHONE 16
607-16 West Schwager Drive

LAWCON BALL DIAMOND
609 West Schwager Drive

UW-WHITEWATER PRAIRIE PRESERVE & KIOSK
700 West Schwager Drive

LAWCON PICNIC SHELTERS & RESTROOMS
607 West Schwager Drive

GENERAL SERVICES GROUNDS
STORAGE & YARD
520 N. Fremont Street

GENERAL SERVICES
GREENHOUSE
512 North Fremont Street

GENERAL SERVICES
DELIVERY DOCK
502 North Fremont Street

PARKING LOT 21
500 North Fremont Street

GENERAL SERVICES BUILDING
500 North Fremont Street

SALT & STORAGE SHED
500 North Fremont Street

GENERAL SERVICES STORAGE
BUILDING
500 North Fremont Street

PARKING LOT 20
400 Lauderdale Drive

EMERGENCY PHONE 18
400-18 Lauderdale Drive

RESIDENCE LIFE FACILITIES
BUILDING
508 North Fremont Street

HAZARDOUS WASTE
STORAGE BUILDING
504 North Fremont Street

RESIDENCE LIFE GROUNDS
STORAGE
506 North Fremont Street

WELLERS HALL
705 Lauderdale Drive

EMERGENCY PHONE 17
695-17 Lauderdale Drive

WELLS HALL
611 Lauderdale Drive

Brown buildings are proposed future buildings per Campus Master Plan

Revisions are shown in **BOLD RED**

Facilities Planning
and Management

University of Wisconsin
Whitewater



CAMPUS ADDRESSES
RE-ALIGNMENT PROJECT
Issued: August 2019

PAGE
7

LAUDERDALE DRIVE, WEST SCHWAGER DRIVE AND NORTH FREMONT STREET ADDRESSES



JEFFERSON CO.
WALWORTH

FUTURE PRESSBOX AND CONCESSIONS BUILDING
1064 West Schwager Drive

BASEBALL SERVICE BUILDING & PRUCHA FIELD AT JAMES MILLER STADIUM
 1062 West Schwager Drive

SOCCER PRACTICE FIELD
920 West Schwager Drive

PERKINS STADIUM AND FIELD
 910 West Schwager Drive

ATHLETIC FIELDS RESTROOM BUILDING
 1050 West Schwager Drive

PRACTICE FIELD
918 West Schwager Drive

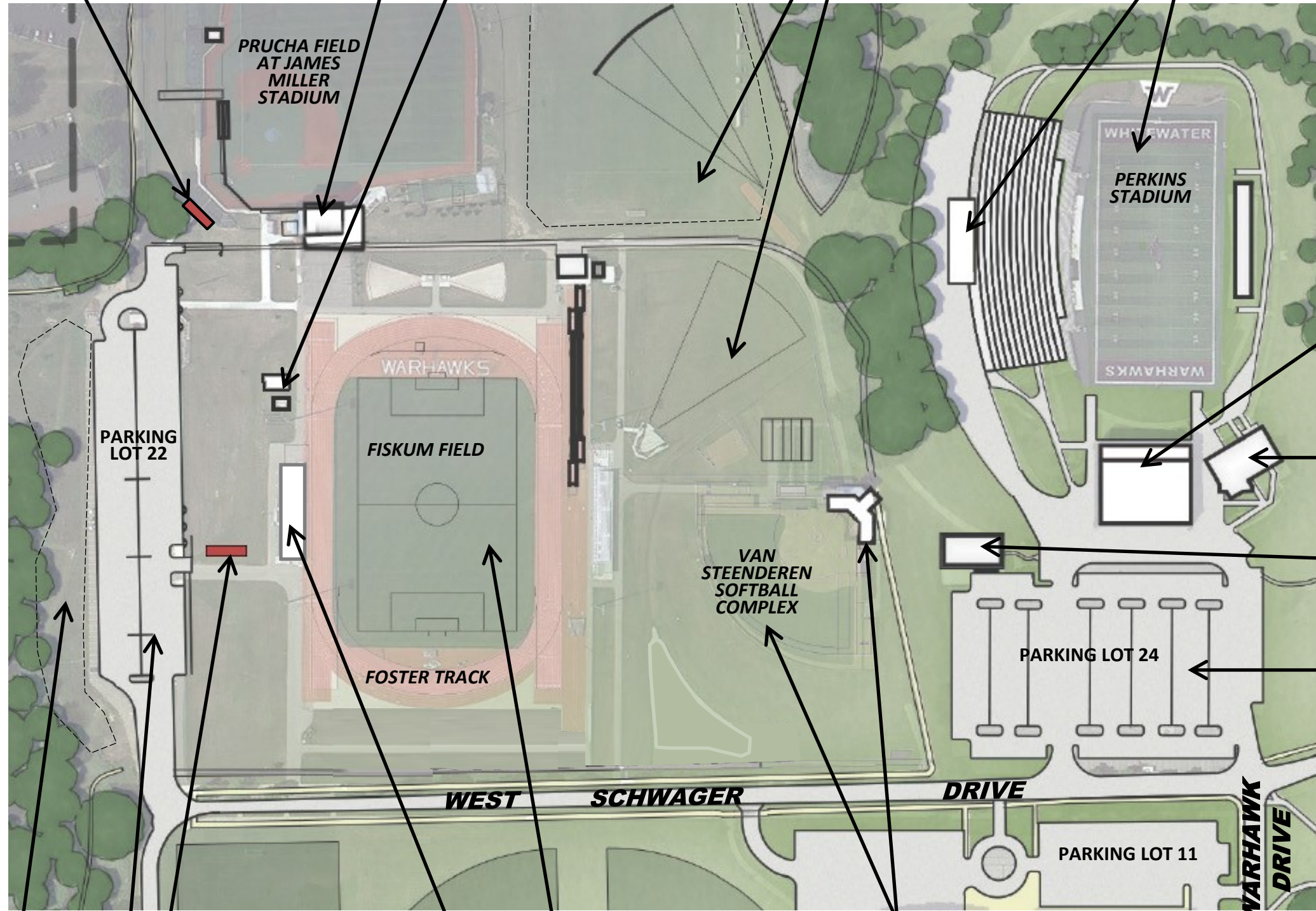

FRISBEE GOLF COURSE
1100 West Schwager Drive

FUTURE ATHLETIC GROUNDS MAINTENANCE BUILDING
1054 West Schwager Drive
PARKING LOT 22
1060 West Schwager Drive

FISKUM FIELD & FOSTER TRACK
1048 West Schwager Drive
TRACK AND FIELD STORAGE BUILDING, STANDS AND PRESSBOX
1052 West Schwager Drive

SOFTBALL SERVICE BUILDING AT VAN STEENDEREN SOFTBALL COMPLEX
 916 West Schwager Drive

STADIUM ATHLETIC SERVICE BUILDING
 904 West Schwager Drive

BEREZOWITZ STUDENT ATHLETIC COMPLEX
 900 West Schwager Drive

COULTHART FAMILY PAVILLION
 912 West Schwager Drive

PARKING LOT 24
 902 West Schwager Drive

WEST SCHWAGER DRIVE ADDRESSES



Revisions are shown in **BOLD RED** Brown buildings are proposed future buildings per Campus Master Plan



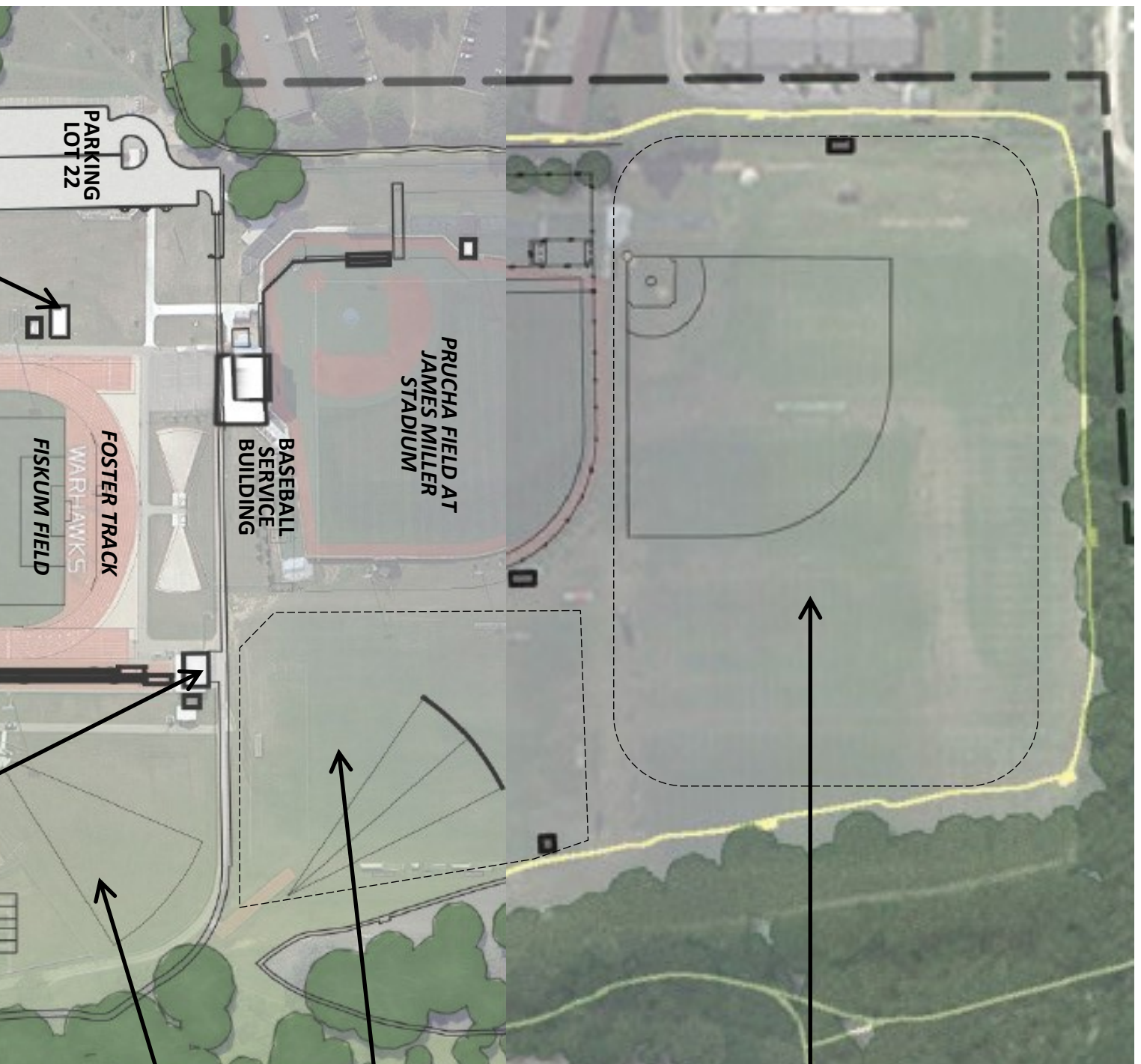

ATHLETIC FIELDS
RESTROOM BUILDING
1050 West Schwager Drive

PARKING LOT 22
FOSTER TRACK
WARHAWKS
FISKUM FIELD

BASEBALL SERVICE BUILDING

PRUCHA FIELD AT JAMES MILLER STADIUM

POINT OF PRESENCE BUILDING
1000 West Schwager Drive

PRACTICE FIELD
918 West Schwager Drive

SOCCER PRACTICE FIELD
920 West Schwager Drive

NORTH PRACTICE FIELDS
924 West Schwager Drive

WEST SCHWAGER DRIVE ADDRESSES
ATHLETIC FIELDS



Revisions are shown in **BOLD RED**

Brown buildings are proposed future buildings per Campus Master Plan

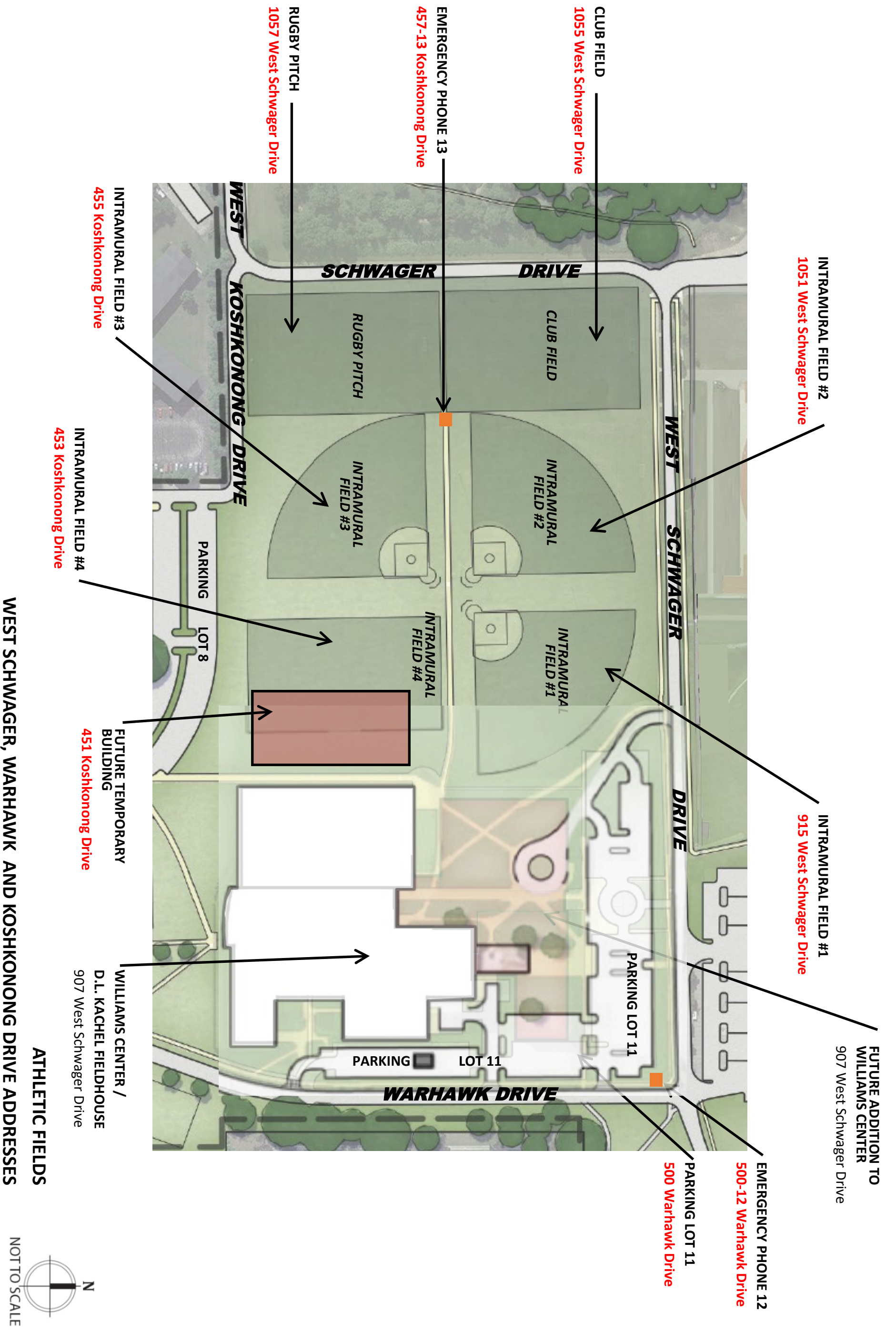

Revisions are shown in **BOLD RED**

Brown buildings are proposed future buildings per Campus Master Plan



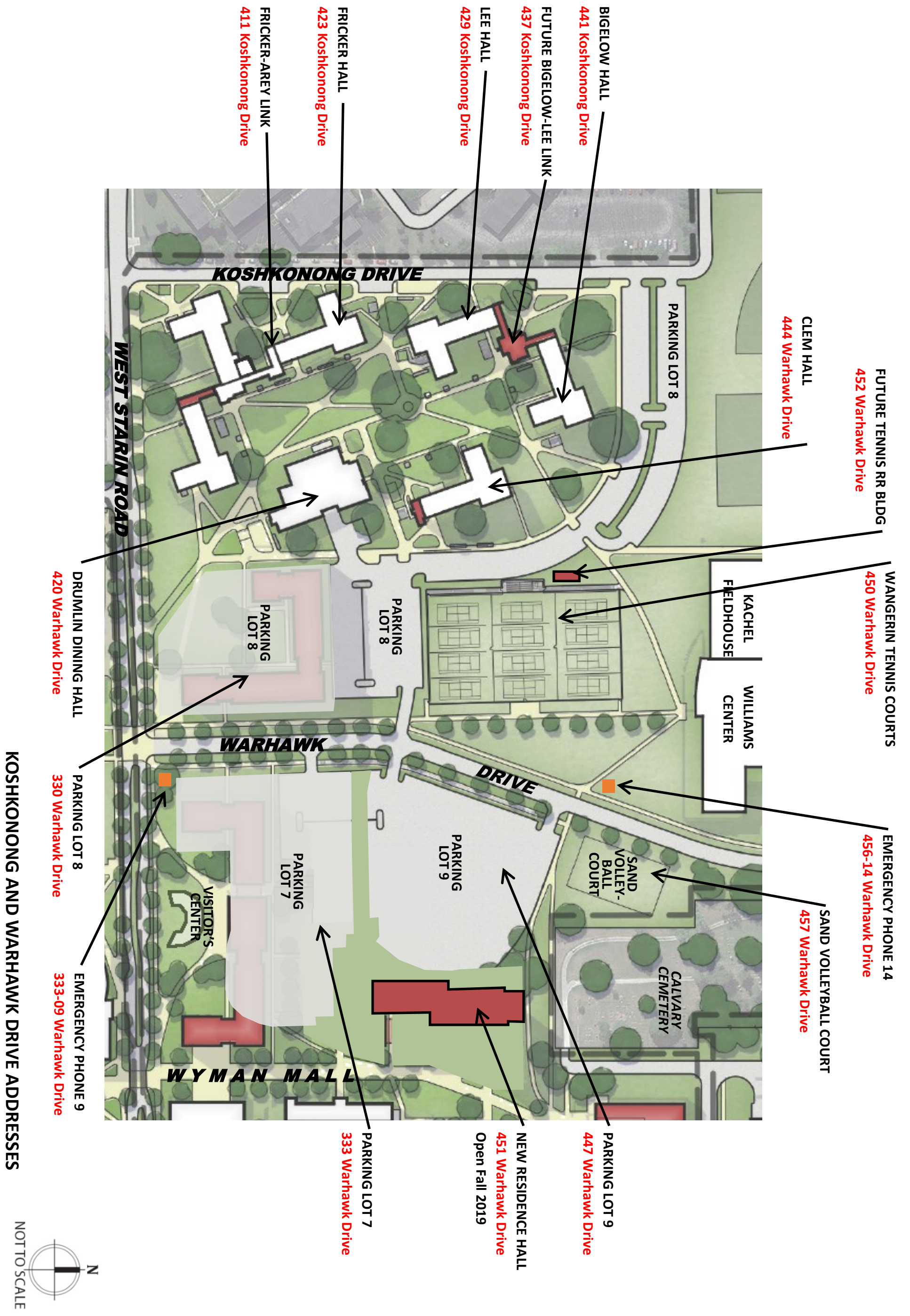

KOSHKONONG AND WARHAWK DRIVE ADDRESSES

Revisions are shown in **BOLD RED**

Brown buildings are proposed future buildings per Campus Master Plan



FACILITY NUMBER	BLDG ABBR	WISBUILD / CDR BUILDING NAME	WISBUILD / CDR BUILDING ADDRESS (STATE - OFFICIAL)	PROPOSED NEW ADDRESS (Aligns with City Addressing Grid)	PROPOSED BUILDING ABBREV. CHANGE	PROPOSED BUILDING NAME CHANGE	COMMENTS
0001	HY	HYER HALL	142 Wyman Mall	800 W. Main Street			Official Campus address. Campus administration is in this building and less expense for stationary change overall. Better alignment with
0002	L	ANDERSEN LIBRARY	141 Wyman Mall	750 West Main Street	AN	ANDERSEN HALL	Although the Andersen Library is the largest function within this building, Andersen Library as a building name no longer accurately represents the diversity of building occupants.
0004	CA	GREENHILL CENTER OF THE ARTS	950 West Main Street	no change			
0004A	YA	IRVIN L YOUNG AUDITORIUM	930 West Main Street	no change			
0005	LT	LAURENTIDE HALL	260 Carter Mall	237 North Prince Street			
0005A	SC	MARY POPPE CHRISMAN SUCCESS CENTER	235 N Prince Street	no change			
0006	AC	OLD MAIN ALUMNI CENTER	800 West Main Street	810 West Main Street			800 W Main proposed to be re-assigned to Hyer Hall.
0007	HH	TIMOTHY J HYLAND HALL	811 West Starin Road	809 West Starin Road			
0008	MG	MCGRAW HALL	155 Wyman Mall	150 Hamilton Green Way			
0009	HE	HEIDE HALL	180 North Prairie Street	no change			
0010	WH	WINTHER HALL	230 North Prairie Street	no change			
0011	RS	ROSEMAN BUILDING	235 Wyman Mall	234 North Prairie Street			
0012	UH	UPHAM HALL	269 Wyman Mall	771 West Starin Road			
0012A	UH	UPHAM GREENHOUSE	269 Wyman Mall	773 West Starin Road			
0014	WC	WILLIAMS CENTER	907 West Schwager Drive	no change			
0015	SB	SOFTBALL BUILDING	916 West Schwager Drive	916 West Schwager Drive		SOFTBALL SERVICES BUILDING	Also shares address with van Steenderen Softball Complex which includes field and building
0017	SS	STADIUM ATHLETIC SERVICE BLDG	904 West Schwager Drive	no change			
0018	ST	PERKINS STADIUM	910 West Schwager Drive	no change			
0019	SA	BEREZOWITZ STUDENT ATHLETIC COM- PLEX	900 West Schwager Drive	no change			
0020	CP	COLTHART FAMILY PAVILLION	912 West Schwager Drive	no change			
0023	TF	TRACK & FIELD STORAGE / PRESSBOXBLDG	West Schwager Drive	1052 West Schwager Drive			previous address doesn't match city grid;
0025		CAMPUS LIGHTING	800 West Main Street	no change			
0027		POINT OF PRESENCE	800 West Main Street	1000 West Schwager Drive		POINT OF PRESENCE BUILDING	
0031	PP	HEATING & CENTRAL CHILLED WATER PLANT	734 West Lauderdale Drive	no change			
0032	GS	GENERAL SERVICES BUILDING	500 North Fremont Street	500 North Fremont Street			
0032	GS	GENERAL SERVICES DELIVERY DOCK	500 North Fremont Street	502 North Fremont Street		GENERAL SERVICES DELIVERY DOCK	Different Entry to Dock & Building than offices portion of building. This is also where Mail Dept and Sustainability office is located
0034	CV	CAMPUS VEHICLE STORAGE	337 Wyman Mall	770 West Starin Road			
0035		SALT & STORAGE SHED	500 North Fremont Street	no change			
0036		HALVERSON LOG CABIN	800 West Main Street	830 West Main Street			
0037		LITTLE RED SCHOOL HOUSE	800 West Main Street	243 North Prince Street			
0038	VC	VISITOR CENTER	826 West Starin Road	no change			

Facilities with address on pedestrian malls, with multiple addresses or shared address with another facility

City and US Post Office have requested that address with letter or number suffixes be changed to single unique address or Unit Number

List continued on next page

ADDRESS CROSSWALK TABLE - BUILDINGS



FACILITY NUMBER	BLDG ABBR	WISBUILD / CDR BUILDING NAME	WISBUILD / CDR BUILDING ADDRESS (STATE - OFFICIAL)	PROPOSED NEW ADDRESS (Aligns with City Addressing Grid)	PROPOSED BUILDING ABBREV. CHANGE	PROPOSED BUILDING NAME CHANGE	COMMENTS
0040	SN	STARIN HALL	901 West Starin Road	no change			
0041A	UC	CONNOR UNIVERSITY CENTER	228 Wyman Mall	190 Hamilton Green Way			
0042	HC	AMBROSE HEALTH CENTER	710 West Starin Road	no change			
0043	MO	MORAINÉ BOOKSTORE	331 Wyman Mall	780 West Starin Road			*On Bookstore website and corner of building. Doesn't match grid
0044	DR	DRUMLIN DINING HALL	1010 West Starin Road	420 Warhawk Drive			
0045	EK	ESKER DINING HALL	420 North Prairie Street	no change			
0046	LA	LAWCON PICNIC SHELTERS	East Schwager Drive	607 East Schwager Drive			
0047		BASEBALL/SOFTBALL DUGOUTS	1062 West Schwager Drive	no change			
0048	BB	BASEBALL SERVICE BUILDING	1062 West Schwager Drive	no change			
0049	RB	ATHLETIC FIELDS RESTROOM BLDG	1050 West Schwager Drive	no change			
0051	OB	OBSERVATORY	800B West Main Street	820 West Main Street			
0051A		OBSERVATORY PLATFORM	800A West Main Street	822 West Main Street			
0052	MC	MCCUTCHAN HALL	253 Carter Mall	239 North Prince Street			
0055	WT	WHITE HALL	847 West Starin Road	no change			
0056	BE	BENSON HALL	1008 West Starin Road	no change			
0057	AR	AREY HALL	1024 West Starin Road	no change			
0058	FR	FRICKER HALL	1022 West Starin Road	423 Koshkonong Drive			
0059	LE	LEE HALL	1020 West Starin Road	429 Koshkonong Drive			
0060	BG	BIGELOW HALL	1018 West Starin Road	441 Koshkonong Drive			
0061	CL	CLEM HALL	1012 West Starin Road	444 Warhawk Drive			
0062	GO	GOODHUE HALL	335 Wyman Mall	790 West Starin Road			Locator shows by gardens and Ambrose Health Center
0063	FI	FISCHER HALL	339 Wyman Mall	771 West Lauderdale Drive			Locator shows where new Res. Hall will be located
0064	KN	KNILANS HALL	411 North Prairie	no change			
0065	TU	TUTT HALL	431 North Prairie	no change			
0066	WR	WELLERS HALL	641 West Lauderdale Drive	705 Lauderdale Drive			Per suggestion of City, East Lauderdale is changed to simply Lauderdale Drive
0067	WL	WELLS HALL	621 West Lauderdale Drive	611 Lauderdale Drive			See note for 0066
0068		RESIDENCE LIFE FACILITIES BLDG	500B North Fremont Street	508 North Fremont Street			
0069		GENERAL SVCS GROUNDS STORAGE	500 North Fremont	500 North Fremont Street			
0070		GENERAL SVCS STORAGE BUILDING	500 North Fremont	500 North Fremont Street			
0071		RESIDENCE LIFE GROUNDS STORAGE	500 North Fremont Street	506 North Fremont Street			
0072	GH	GENERAL SVCS GREENHOUSE	500 North Fremont Street	512 North Fremont Street			
0080	FA	FRICKER-AREY LINK	1022-1 West Starin Road	411 Koshkonong Drive			
0080A	AB	AREY-BENSON LINK	STARIN ADDRESS	403 Koshkonong Drive			Access by Emergency Responders from Koshkonong Drive
0082		NEW RESIDENCE HALL #1	UNDER CONSTRUCTION	451 Warhawk Drive		New Hall	This is an operational place holder while another name is being approved.
0094	HZ	HAZARDOUS WASTE STORAGE BLDG	500A North Fremont Street	504 North Freemont Street			
0095		MEDICAL WASTE STORAGE FACILITY	710 West Starin Road	no change			Located at Ambrose Health Center in parking lot - Keep same address as Ambrose for ease of documentation
0201		Cambridge Apartments	375 North Harmony Lane	no change			Leased Property
0202	CEC	Community Engagement Center	1260 West Main Street	no change			Leased Property (former Sentry)

List continued on next page

ADDRESS CROSSWALK TABLE - BUILDINGS continued

FACILITY NUMBER	BLDG ABBR	WISBUILD / CDR BUILDING NAME	PROPOSED NEW ADDRESS (Aligns with City Addressing Grid)	PROPOSED BUILDING ABBREV. CHANGE	PROPOSED BUILDING NAME CHANGE	COMMENTS
FUTURE FACILITIES						
0021		FUTURE Presbox/Concession Building	1064 West Schwager Drive			Located at Miller Stadium (baseball)
0022		FUTURE Athletic Grounds Maintenance Building	1054 West Schwager Drive			
0026		FUTURE Parking Structure (Lot 12)	130 Hamilton Green Way			
0039		FUTURE Tennis RR Building	452 Warhawk Drive			Near Wangeren Tennis Courts
0080A	AB	FUTURE Arey-Benson Link	1016 West Starin Road			
0081	BL	FUTURE Bigelow-Lee Link	437 Koshkonong Drive			
0083		FUTURE New Residence Hall #2 (facing Starin)	824 Starin Road			
0084		FUTURE New Residence Hall #3 (facing Prairie)	350 North Prairie Street			
0085		FUTURE New Residence Hall #4 (east of Drumlin)	906 West Starin Road			
0086		FUTURE New Residence Hall #5 (at Esker location)	430 North Prairie Street			
0090		FUTURE Academic Building (Carter Mall)	225 North Prince Street			
0091		FUTURE Academic Building (Starin & Prairie)	250 North Prairie Street or 725 W Starin Rd			
0092		FUTURE Dining Hall (across from Esker)	725 West Lauderdale Drive			

NOTES:

1. This is not an exhaustive list of future facilities and does not guarantee that these will be constructed. They are facilities that have been identified as part of the comprehensive master plan and successive capital budget planning exercises. The addresses assigned are placeholders in the event that they are constructed.

ADDRESS CROSSWALK TABLE - FUTURE BUILDINGS

COMMON NAME (From UWW Police)	ADDRESS (From UWW Police - date unknown)	PROPOSED NEW ADDRESS (Aligns with City Addressing Grid)	PROPOSED NEW Designation	COMMENTS
UWW Lot 1	105 N Prince St	105 North Prince Street		
UWW Lot 2	165 N Prince St	221 North Prince Street		
UWW Lot 3	295 N Prince St	259 North Prince Street		Starin Hall - Reserve Lot and meter parking
UWW Lot 4	325 N Prairie St	325 North Prince Street		No longer has access from Starin but does from Warhawk
UWW Lot 7	830 W Starin Rd	333 Warhawk Drive		
UWW Lot 8a	320A Warhawk Dr	320 Warhawk Drive		
UWW Lot 8b	320B Warhawk Dr	<i>omit designation</i>		
UWW Lot 8c	500D N Prairie St	424 North Prairie Street	Lot 8C (Esker Service Lot)	Re-assign Designation to different lot
UWW Lot 9	335 Warhawk Dr	447 Warhawk Drive		
UWW Lot 11 A.	420A Warhawk Dr	500 Warhawk Drive	Lot 11	omit A/B designation
UWW Lot 11 B	420B Warhawk Dr	<i>omit designation</i>		omit A/B designation
UWW Lot 12 A.	120A N Prairie St	160 Hamiltkon Green Way		enter off of new universty street
UWW Lot 12 B	120B N Prairie St	122 North Prairie Street	UWW Lot 12B, Andersen Service Lot	ADA, service stalls, reserved and meter parking. Technically part of Lot 12 but satellite similar to Lot 12A
UWW Lot 12 C	120C N Prairie St	120 North Prairie Street	Lot 12	Omit C/D designations
UWW Lot 12 D	120D N Prairie St	<i>omit designation</i>		Omit C/D designations
UWW Lot 13	200 N Prairie St	200 North Prairie Street		Btwn Winther and Heide - Reserve lot and meter parking
UWW Lot 14	721 W Starin Rd	240 North Prairie Street		Change to N Prairie now so if new building does get built per master plan, parking lot address won't need to change
UWW Lot 15	310 N Prairie St	310 North Prairie Street		Ambrose HC
UWW Lot 16	734B W Starin Rd	790 West Starin Road		Same as Goodhue Hall
UWW Lot 17	735 W Lauderdale Dr	735 West Lauderdale Drive		
UWW Lot 18	500 North Prairie Street	500 North Prairie Street		
UWW Lot 18c	500C North Prairie Street	<i>omit designation</i>		
UWW Lot 19	501 N Prairie St or 443 N Prairie St	501 North Prairie Street		
UWW Lot 20	400 W Lauderdale Dr	400 Lauderdale Drive		This section is not West. East identifier was eliminated per City's suggestion.
UWW Lot 21	500P N Fremont St	500 North Fremont Street		Same as General Services Building
UWW Lot 22	1080 W Schwager Dr	1060 West Schwager Drive		aligns better with grid and adjacent address
UWW Lot 23	360 N Prairie St	360 North Prairie Street		
UWW Lot 24	900 W Schwager Dr	902 West Schwager Drive		900 is building address for SAC, but since there are multiple buildings adjacent to and it is a larger lot with events, it should have a separate address
UWW Lot 25	1260 W Main St	1260 West Main Street		This is at the CEC
		800 West Main Street	UWW Hyer Hall Lot	Reserve Lot and metered and ADA parking
		239 North Prince Street	UWW Lot 2R	Resident Parking Only; designation exists on current map
		297 North Prince Street	UWW Hyland Hall Service Lot	ADA and Service stalls only

NOTES:

1. Lots directly associated with a building have the same address as the building, unless accessed from another road. Examples would be lots at General Services (Lot 21), Physical Plant, Hyer Hall and Goodhue (Lot 16). Examples of lots associated with buildings but having different access point would be Lot 1 at CA, Lot 3 at Starin Hall, and Ambrose Health Center.
2. Larger lots that service multiple buildings and outdoor areas should be assigned a unique address.

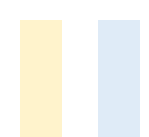

Facilities with address on pedestrian malls, with multiple addresses or shared address with another facility

City and US Post Office have requested that address with letter or number suffixes be changed to single unique address or Unit Number

ADDRESS CROSSWALK TABLE - PARKING LOTS

COMMON NAME	ADDRESS ON FILE	PROPOSED NEW ADDRESS (Aligns with City Addressing Grid)	PROPOSED NEW Designation	COMMENTS
Chopp Arboretum		920 West Main Street	Chopp Arboretum and Memory Garden	
Friar Woods	1062A W Schwager Dr	800 West Schwager Drive		doesn't fit address grid
Hamilton Green		140 Hamilton Green Way		This is a manmade feature that is surrounded by 4 buildings. No specific events can occur in this location, only around it, therefore, emergency calls will most likely utilize closest building as reference point for location.
Minneska Water Feature	751A W Starin Rd	<i>omit address assignment</i>		
Salisbury Arboretum		780 West Main Street		
UW-Whitewater Prairie Preserve		700 West Schwager Drive		Includes Kiosk at same address
Ball Diamond		609 West Schwager Drive	LAWCON Ball Diamond	
Fiskum Field & Foster Track		1048 West Schwager Drive		
Frisbee Golf	1100 W Schwager Dr	1100 West Schwager Drive	Frisbee Golf Course	
Prucha Field at Miller Stadium	1062C W Schwager Dr	1062 West Schwager Drive		Same as Baseball Service Building
Intramural Fields	400A Koshkonong St	<i>omit address assignment</i>		too many fields over large area - need to break it down
		915 West Schwager Drive	Intramural Field #1	
		1051 West Schwager Drive	Intramural Field #2	
		1055 West Schwager Drive	Club Field	
		1077 West Schwager Drive	Rugby Pitch	
		455 Koshkonong Drive	Intramural Field #3	
		453 Koshkonong Drive	Club Soccer Field	
North Practice Field	1062B W Schwager Dr	924 West Schwager Drive		
Practice Field (unidentified)		918 West Schwager Drive	Practice Field	Practice Field (north of softball)
Sand Volleyball Complex	385 Warhawk Drive	457 Warhawk Drive	Sand Volleyball Court	
Soccer Practice Fields	1062D W Schwager Dr	920 West Schwager Drive		
Tennis Courts (lot 23)	362 N Prairie St	362 North Prairie Street	LAWCON Tennis Courts	
Tennis Courts (lot 8)	380 N Warhawk Dr	450 Warhawk Drive	Wangerin Tennis Complex	
van Steenderen Softball Complex		916 West Schwager Drive		Same address as Softball Services Building

NOTES:

- Similar to parking lots, fields directly associated with a building should have the same address as the building, unless accessed from another road.
Examples would be: Prucha Field/Miller Stadium - same address as Baseball Service Building (1062). Future Pressbox would be 1064 West Schwager.
Likewise, van Steenderen Softball Complex shares an address with Softball Service Building at 916 West Schwager Drive.

City and US Post Office have requested that address with letter or number suffixes be changed to single unique address or Unit Number

ADDRESS CROSSWALK TABLE - OUTDOOR AREAS AND ATHLETIC FIELDS

COMMON NAME	LOCATION ON CAMPUS	ADDRESS ON FILE	PROPOSED NEW ADDRESS (Aligns with City Addressing Grid)	PROPOSED NEW Designation	COMMENTS
Phone 1	Lot 1 in front of CA	105X N Prince Street	105-01 North Prince Street		
Phone 2	Just north of Lot 1 on east end	822X W Main St	918-02 West Main Street		
Phone 3	on hill between Lot 1 and Hyer lot	820X W Main St	820-03 West Main Street		
Phone 4	Lot 2 NW corner of CA	165X N Prince St	165-04 North Prince Street		
Phone 5	By Success Center	235X N Prince St	235-05 North Prince Street		Same address as SC;
Phone 6	Carter Mall on east end of Lot 2	163X N Prince St	223-06 North Prince Street		doesn't match grid; align with Lot 2 address
Phone 7	Just north of Log Cabin on drumlin	800BX W Main St	830-07 West Main Street		align with Log Cabin Address
Phone 8	On path between Observatory platform and Alumni Building	800DX W Main St	822-08 West Main Street		align with platform address
Phone 9	Warhawk & Starin (NE) in Lot 7	830X W Starin Rd	333-09 Warhawk Drive		align Lot 7 address
Phone 10	South side of Starin by Upham and Lot 14	725X W Starin Rd	729-10 West Starin Road		align with Upham Hall
Phone 11	Lot 14 between Upham and Roseman	721X W Starin Rd	240-11 North Prairie Street		align with new address for Lot 14
Phone 12	Warhawk & Schwager (SW corner)	420X Warhawk Dr	500-12 Warhawk Drive		align with Lot 11 address
Phone 13	Intramural Fields (center)	400X Koshkonong St	457-13 Koshkonong Drive		align with Intramural field #3 address
Phone 14	Warhawk Dr (across from Sand VB)	386X N Warhawk Dr	456-14 Warhawk Drive		omit N.; align with tennis courts
Phone 15	Lot 19 north side	501X N Prairie St	501-15 North Prairie Street		align with Lot 19 address
Phone 16	LAWCON Picnic Shelter	601X W Schwager Dr	607-16 East Schwager Drive		align with LAWCON picnic shelter address
Phone 17	E Lauderdale just north of Wells Hall	600X W Lauderdale St	695-17 Lauderdale Drive		
Phone 18	Lot 20 entrance on E Lauderdale Dr	520X W Lauderdale St	400-18 Lauderdale Drive		Lot 20 address
Phone 19	Carter Mall between White and Starin Halls	871X W Starin Rd	851-19 West Starin Rd		
Phone 20	Wyman Mall North & Fischer Hall	739X W Lauderdale St	771-20 West Lauderdale Drive		
Phone 21	Lot 12A north side	120X North Prairie St	160-21 Hamilton Green Way		align with lot 12A address

NOTES:

1. Previously, an X suffix in the address denoted emergency phone location. However, even though emergency phones will not receive mail, the USPO and City have asked for addresses without a letter suffix. The compromise was to use the phone ID # as the suffix.
2. Phones located in parking lots should share same address, unless there are multiple phones in a lot.
3. Phones located near entrance to a facility should share address with that facility.

ADDRESS CROSSWALK TABLE - EMERGENCY PHONES